

inspired LED **Tiger Paw™ Screw Terminal** **Mid-connector**

Inspired LED's patented solderless **Tiger Paw Connectors** are the perfect solution for in-field LED customization and system design. These innovative accessories pair easily with Inspired LED flex strips to allow for a quick, convenient installation, making the perfect low-voltage lighting system for a snap!

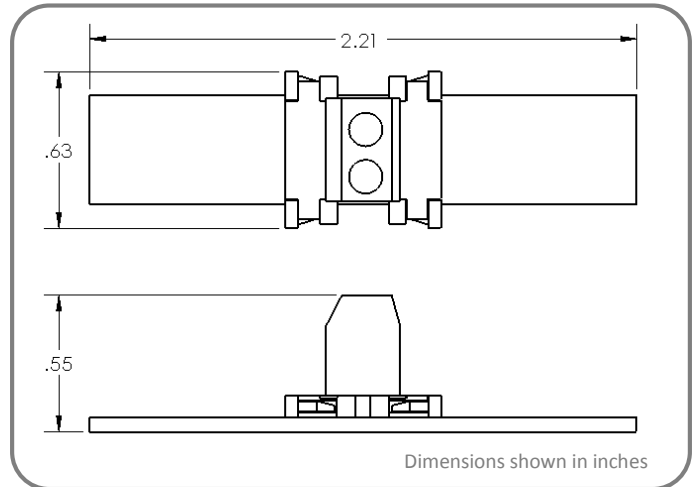
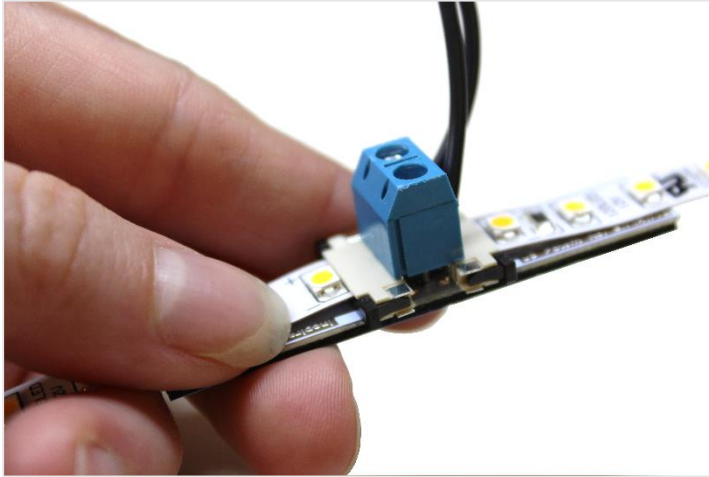

Product Specifications:

- Solderless termination for 8-10mm LED flex strips to 16-22 AWG wire
- Max Load- 5 AMPs
- Industry proven locking system meets shock and vibration requirements for IEC 60068-2-27
- U.S. Patent No. 8,714,772

Instructions:

- 1** Use scissors to cut LED strips to length along copper solder pads, located over 3 LEDs

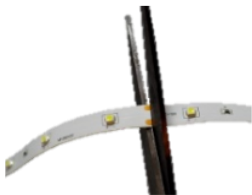

- 2** Take hold of black sliding latch and pull outward to open

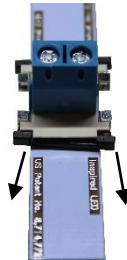

- 3** Peel back adhesive lining on LED strips

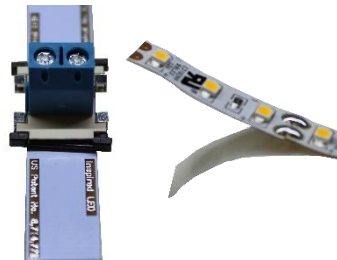

- 4** Taking note of (+) polarity of LEDs, insert flex strips into gaps above the black sliding latches and beige top piece



- 5** Make sure LED strips are centered and fully inserted before sliding black latches firmly closed and pressing on adhesive



- 6** Use small screw driver to loosen screws on the top of connector piece



- 7** Strip cable back ¼" to expose (+) and (-) wire, (if using Inspired LED cable, white writing indicates positive polarity)



- 8** Insert wire (matching polarity) tighten screws and connect to class 2 power source to verify connections, then install LED flex strips as needed



Troubleshooting: If LEDs are flickering, double check connection to be sure flex is fully inserted and secured, if no lights turn on check to be sure polarities are properly matched

Mouser Electronics

Authorized Distributor

Click to View Pricing, Inventory, Delivery & Lifecycle Information:

Inspired LED:

3548